

PHILLIPS COUNTY
COUNTY ROADWAY OCCUPANCY AGREEMENT

AGREEMENT NUMBER _____

Underground Construction and Maintenance for _____
(pipeline, waterline etc.)

Applicant	Address
-----------	---------

Underground Construction of a _____ that will be across
County Road _____ from Sec. _____ to Sec. _____, T _____ N, R _____ W.
(Include legal description of property crossing from and property crossing to and county roads being crossed).

1. All work shall be done in a workman like manner. The fill will be properly compacted and the road surface will be replaced to meet the existing surface conditions. The right-of-way shall be left in a condition satisfactory to the County Road Manager.
2. The Owner shall hold the County harmless from any damage that may result to said roadway because of the construction or maintenance of said _____ and also safeguard and protect adjacent property.
3. The County will assume no responsibility for damage to the _____ occasioned by County construction or maintenance operations.
4. The County will give the Owner sufficient notice of any proposed construction or maintenance work that is likely to expose the _____ in order that Owner can arrange to protect the service and avoid damage.
5. The County will be furnished an "as built" drawing of the completed project.
6. The Owner shall be responsible for providing proper signing and flagging during construction.
7. The Owner will be responsible for locating any other underground utilities in the area before placing this _____.
8. Expected project completion date: _____

Owner

Chairman of Board of Commissioners

Date

Date

The attached project inspection report must be turned into the Administration office at project completion. Inspection by Phillips County Road & Bridge Manager will be the final approval.

Return this form to the Phillips County Administration Office after the project is complete

COUNTY ROAD OCCUPANCY AGREEMENT

Phillips County is hereby notified that the Road Occupancy Agreement _____ approved on _____ is now completed and ready for inspection.

Owner Representative

Date

The Road Occupancy Agreement covered by and approved on _____

Has been inspected by the Phillips County Road and Bridge Manager.

- 1) Inspection Report: There are no additional requirements and final approval is given _____(initial)
- 2) The following additional items need to be completed before final approval is granted by the county:

If the owner needs to perform additional work, this form will need to be re-submitted for review and approval.

Road and Bridge Manager

Date

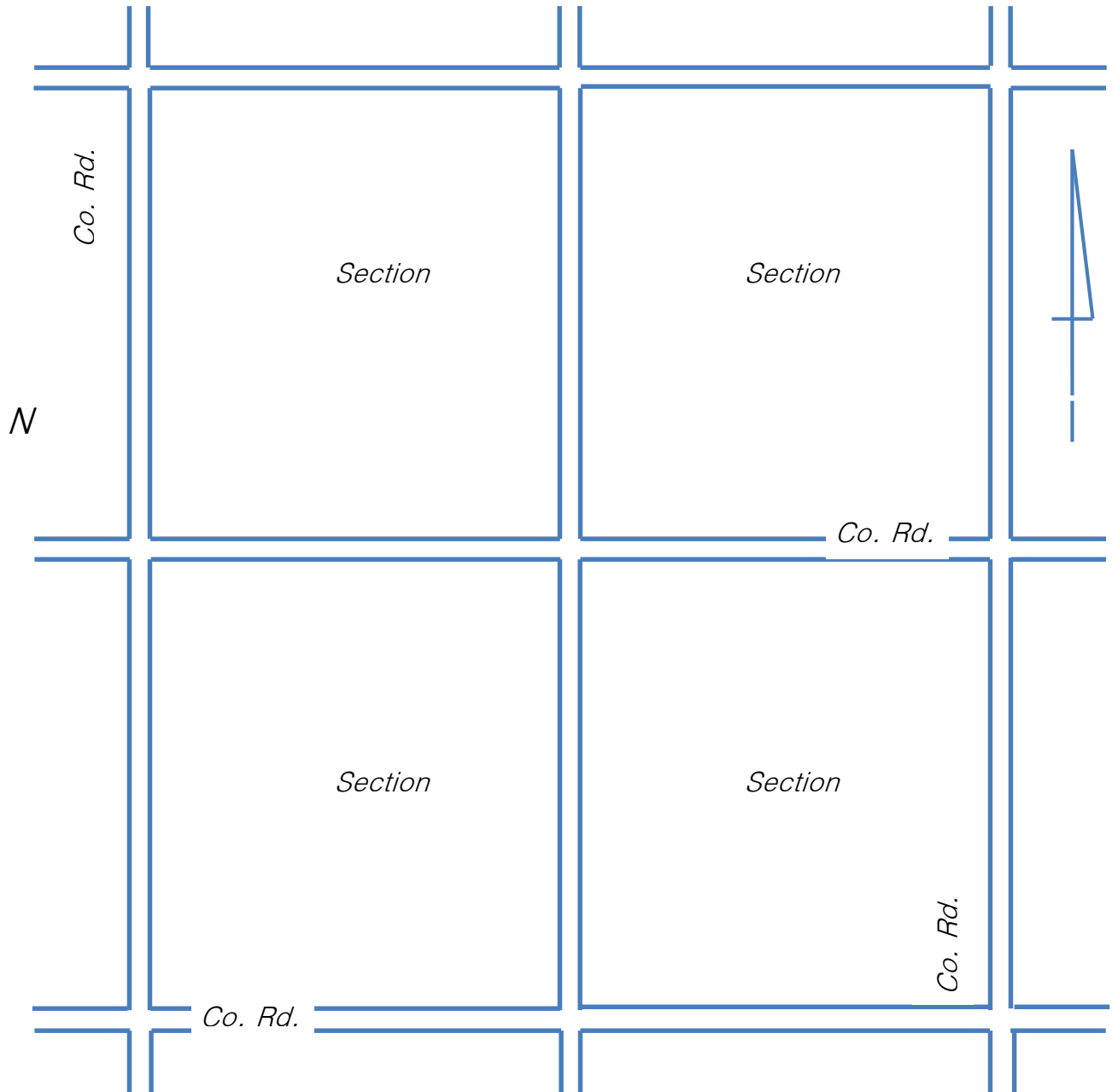

The crossing goes from Sec _____, T_____N, R_____W to Sec _____, T_____N, R_____W across County Road _____.

The crossing is _____ feet _____ (south, north, east or west) of _____

(Example: intersection of Co Rd 2 & 7, the ¼ of Sec 5, the county bridge or my red barn)

The crossing is _____ (Example: 110V electric line, 3" water line, 4" sewer line, fiber optic line) which is buried _____ inches deep and _____ is _____ is not in a _____.(Example: conduit, culvert, pipe).

Show the crossing and any reference points on the diagram.

PHILLIPS COUNTY, COLORADO
PLANNING & ZONING FEES
EFFECTIVE: AUGUST 1, 2017

Zoning Amendment	\$100 plus cost of advertising
Conditional Use Permit	\$100 plus cost of advertising
Subdivision Exemption	\$50 plus recording fees (\$12 for first page, \$5 each additional page, plus \$1 surcharge per document)
Building Permit	\$ 30 plus the 1% use tax
Road Crossings	\$150 for boring under each dirt or gravel road. \$400 for trenching across each dirt or gravel road (\$400 trenching refundable deposit will be collected) \$100 for locally based utility companies
Agricultural Use Permit Fees (For Trenching or Boring)	There will be a \$100.00 fee for non-utility cuts (i.e. agricultural landowners who are required to cut county rights-of-way to provide utility services for agricultural production or a farm residence on their own property). Minimum depth is to be 48".
Right-of-way impacts plus road crossing fee.	\$20 per mile for laying telephone lines in right-of-way Graduated fee per foot for burying pipelines in the right-of-way plus road crossing fee.

Graduated Fees	
Ditch Width	Cost per foot
½" to 8"	\$0.14
8+ to 16	0.20
16+ to 24"	0.35
24+ to 42"	0.60
42+ "	0.72