

PHILLIPS COUNTY
COUNTY ROADWAY OCCUPANCY AGREEMENT
ROAD SURFACE USE AND MAINTENANCE FOR A SEISMOGRAPH SURVEY.

Applicant

Address

City / St / Zip Code

Surface Seismic Survey to carry seismic vibrators between and including Road # _____ and Road # _____ and between and including Road # _____ and Road # _____.
(Include legal description of property crossing from and property crossing to and county roads being crossed).

-
1. All work shall be done in a workman like manner. If there is damage to the roadway, replacement fill will be properly compacted and the road surface will be replaced to meet the existing surface conditions. The right-of-way shall be left in a condition satisfactory to the District Road Foreman.
 2. _____ shall hold the County harmless from any damage that may result to said roadway because of the vibrating on road surface of said survey line, and also safeguard and protect adjacent property.
 3. The County will assume no responsibility for damage to the survey operations occasioned by County construction or maintenance operations.
 4. The County will give _____ sufficient notice of any proposed construction or maintenance work that is likely to hamper operations in order that _____ can arrange to protect the surface cables and avoid damage.
 5. The County will be furnished a plat map of the proposed project, and _____ will notify the County of beginning and completion dates.
 6. _____ shall be responsible for providing proper signing and flagging during construction.
 7. _____ will be responsible any damage to other underground utilities in the area.

Owner

Chair of Board of Commissioners

Date

Date

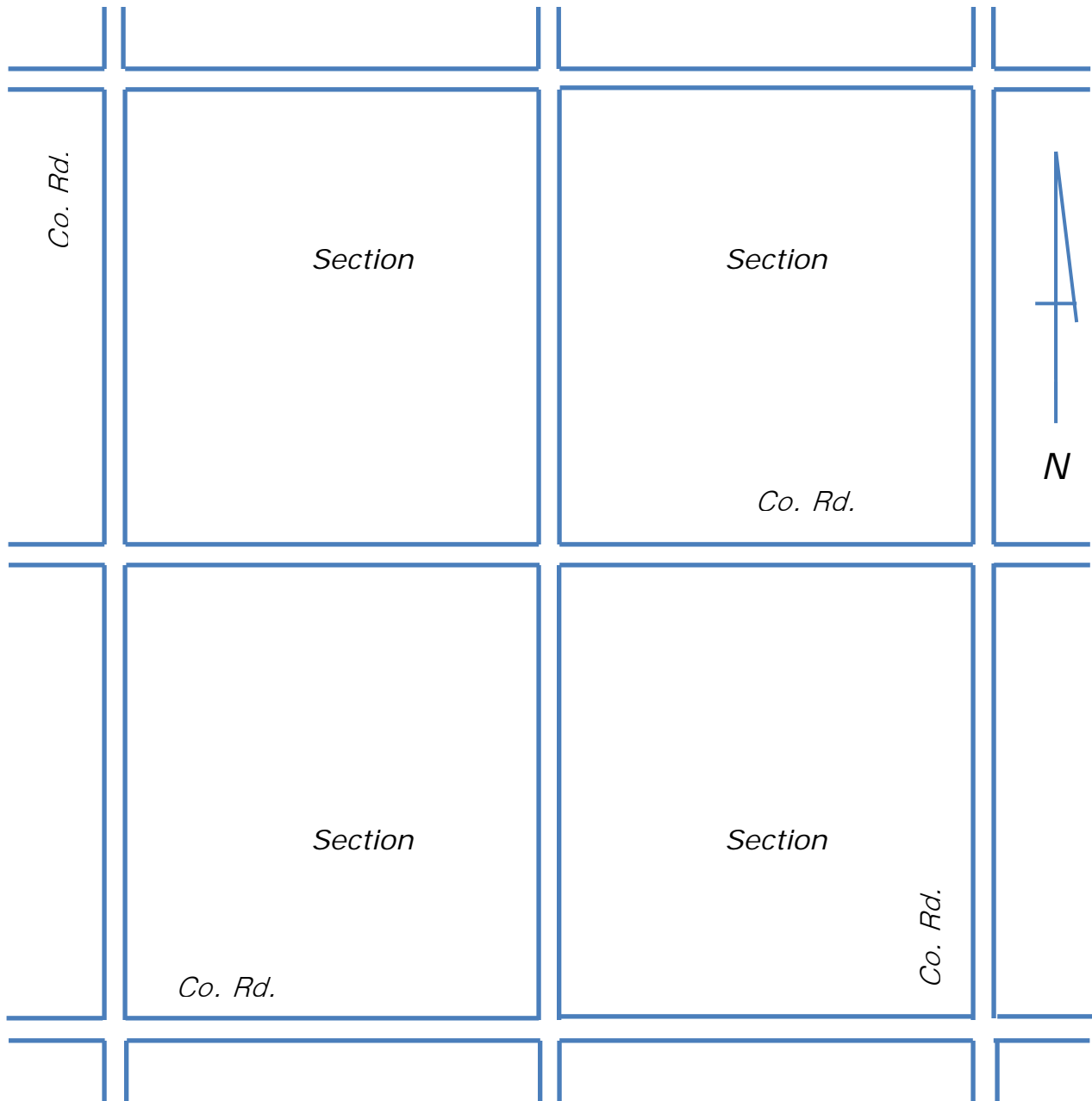

The Surface Seismic Survey goes from Sec _____, T_____N, R_____W to Sec _____, T_____N, R_____W across County Road(s) _____.

Show the survey path and any reference points on the diagram.

PHILLIPS COUNTY, COLORADO
PLANNING & ZONING FEES
EFFECTIVE: AUGUST 1, 2017

Zoning Amendment	\$100 plus cost of advertising
Conditional Use Permit	\$100 plus cost of advertising
Subdivision Exemption	\$50 plus recording fees (\$12 for first page, \$5 each additional page, plus \$1 surcharge per document)
Building Permit	\$ 30 plus the 1% use tax
Road Crossings	\$150 for boring under each dirt or gravel road. \$400 for trenching across each dirt or gravel road (\$400 trenching refundable deposit will be collected) \$100 for locally based utility companies
Agricultural Use Permit Fees (For Trenching or Boring)	There will be a \$100.00 fee for non-utility cuts (i.e. agricultural landowners who are required to cut county rights-of-way to provide utility services for agricultural production or a farm residence on their own property). Minimum depth is to be 48".
Right-of-way impacts plus road crossing fee.	\$20 per mile for laying telephone lines in right-of-way Graduated fee per foot for burying pipelines in the right-of-way plus road crossing fee.

Graduated Fees	
Ditch Width	Cost per foot
½" to 8"	\$0.14
8+ to 16	0.20
16+ to 24"	0.35
24+ to 42"	0.60
42+"	0.72